

LIDAR data
flown in October 2013

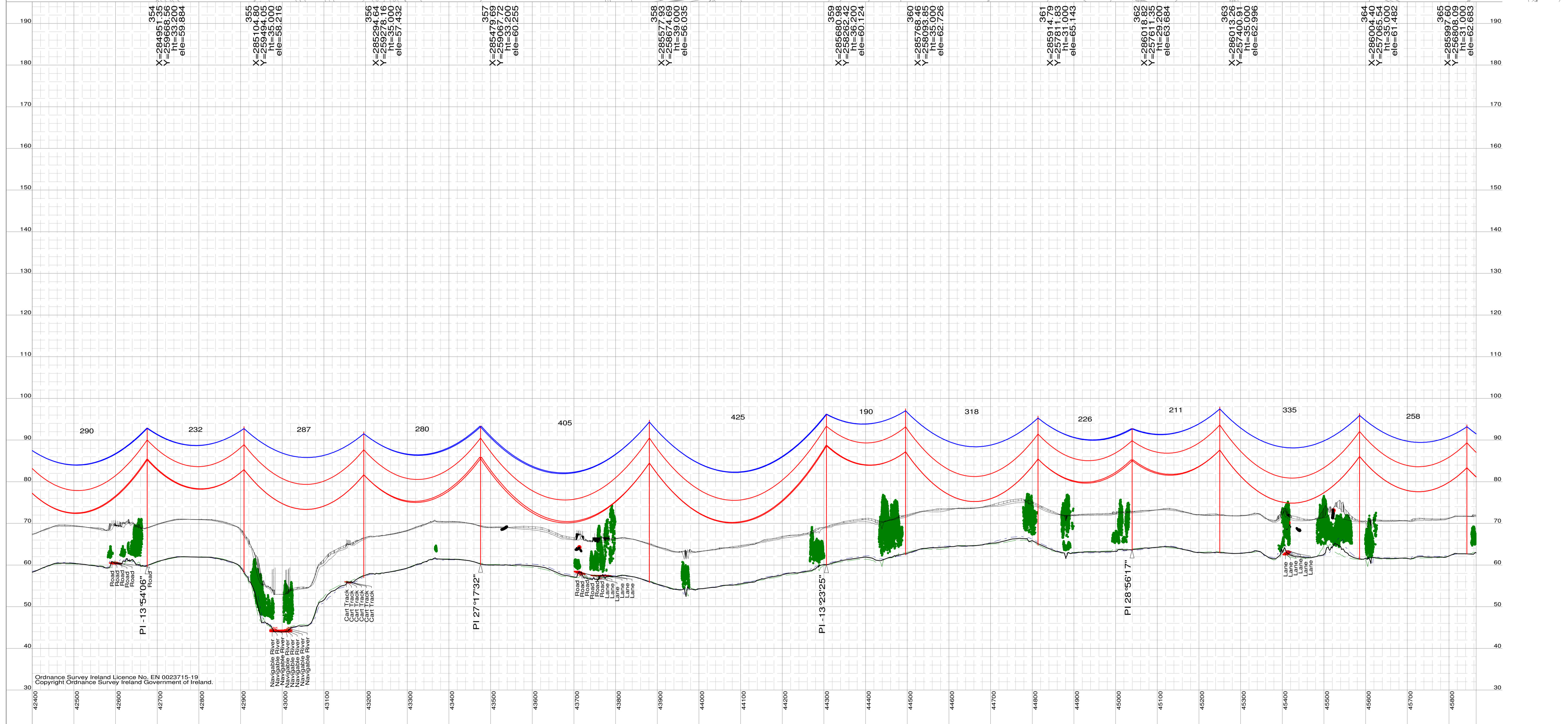

Drawing Key

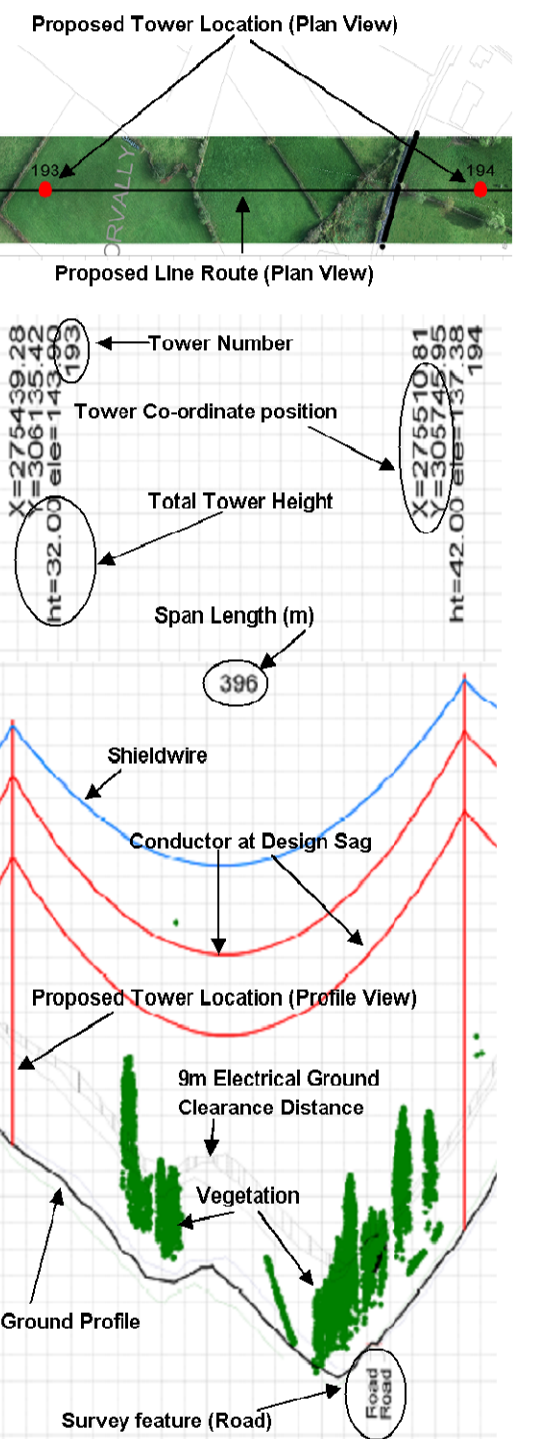

Notes:
Figured Dimensions only to be taken from this drawing.
All levels relate to Ordnance Survey Datum at Main Head

Ordnance Survey Ireland Licence No. EN 0023715-19
Copyright Ordnance Survey Ireland Government of Ireland.

COPYRIGHT © INTERNATIONAL LIMITED
All rights reserved. No part of this work may be modified or reproduced or copied in any form or by means - graphic, electronic or mechanical, including photocopying, recording, taping or information and retrieval system, or used for any purpose other than its designated purpose, without the written permission of ESB International limited.

ESB International
18/21 Stephen Court, St Stephen's Green, Dublin 2
Tel: 353 1 703 8000 Email: marketing@esb.ie Web: www.esb.ie
ESB International is a trading name of ESB Engineering & Facility Management Ltd
Registered Office: as above Registered in Ireland No. 155249

PURPOSE OF ISSUE:
Preliminary unless indicated

For Information Planning
Client Approval Revised
ESB Legal Services Tender
Construction As-Built Drawing

CLIENT:
EirGrid

PROJECT:
North South 400kV Interconnection Development

DRAWING TITLE:
**Meath Study Area (MSA) Proposed Line Route Design
Plan & Profile**

DRAWN: J.D.	PRODUCED: J.D.	VERIFIED: N.L.	APPROVED: B.G.	APP DATE: Mar 15
CLIENT REF: (Planning Drawing Reference) MT - 005-027			No. of Sheets: 27/32	SIZE: A1
DRAWING NUMBER: DRAFT PE687 - D141 - 132 - 027 - 000			SCALE: V: 1:500 H: 1:5000	
			SHEET REV	